

- THIS DRAWING IS TO BE READ IN CONJUNCTION WITH ALL ENGINEERS & ARCHITECTS DRAWINGS FIGURED DIMENSIONS ONLY (NOT SCALING) TO BE USED, WHERE A CONFLICT OF INFORMATION EXISTS OR IF IN ANY DOUBT - ASK.
- CONSULTANTS TO BE INFORMED IMMEDIATELY OF ANY DISCREPANCIES BEFORE WORK PROCEEDS.

- NOTES:
- DETAILED DESIGN OF THE PAVEMENT BUILD-UP, THE FIN DRAIN LAYOUT & FIN DRAIN OUTLET LOCATIONS BY THE SUPPLIER IN ACCORDANCE WITH BS7533 PART 13.
  - CONTRACTOR SHALL ALLOW FOR TANKING (USING AN IMPERMEABLE LINER APPROVED BY THE PERMEABLE PAVING SUPPLIER) OF ALL PERMEABLE PAVED AREAS.

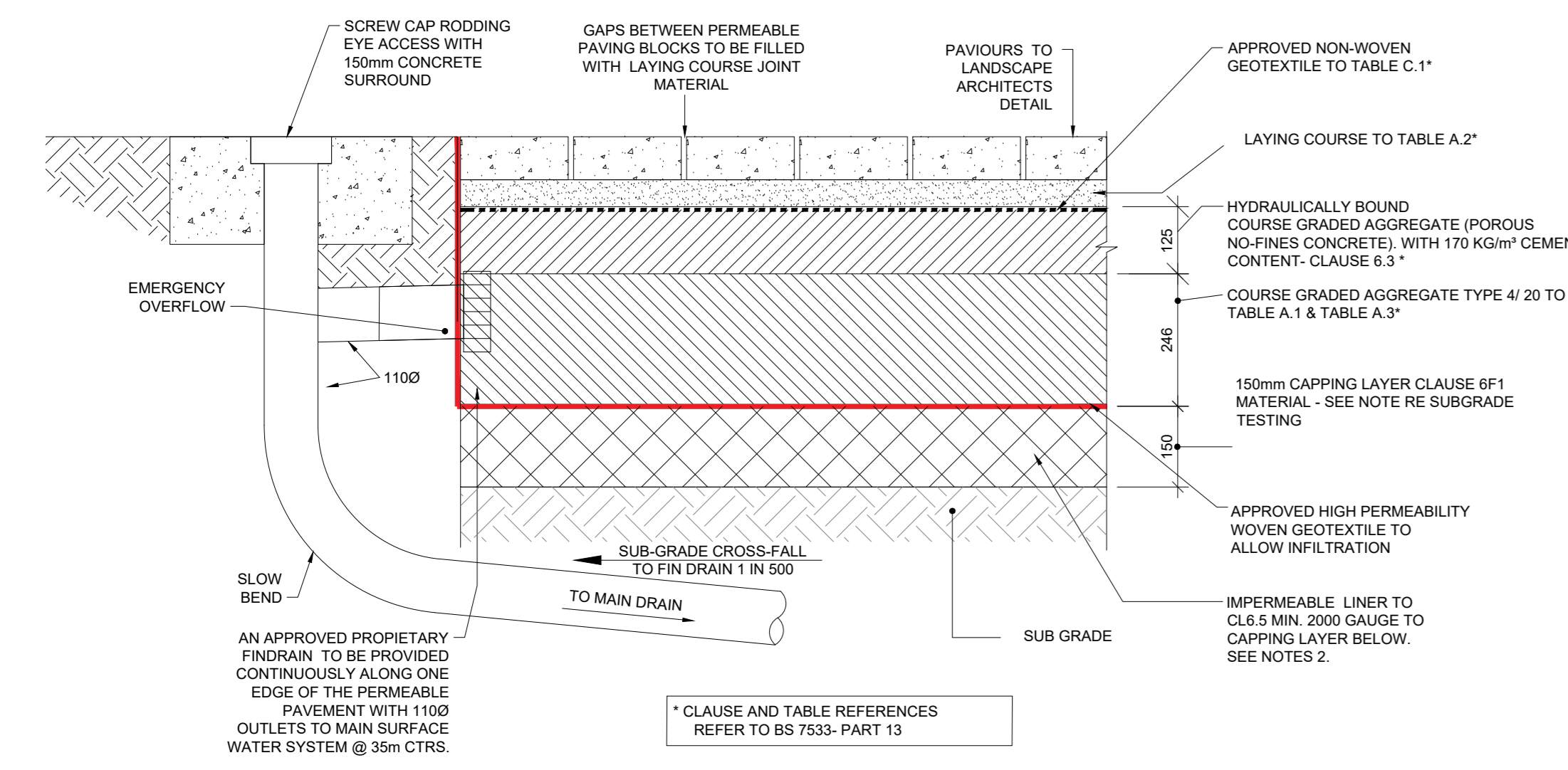

**TYPICAL PERMEABLE PAVING DETAILS AND FIN DRAINAGE DETAILS**  
SCALE @ A0: 1:10  
SCALE @ A2: 1:20

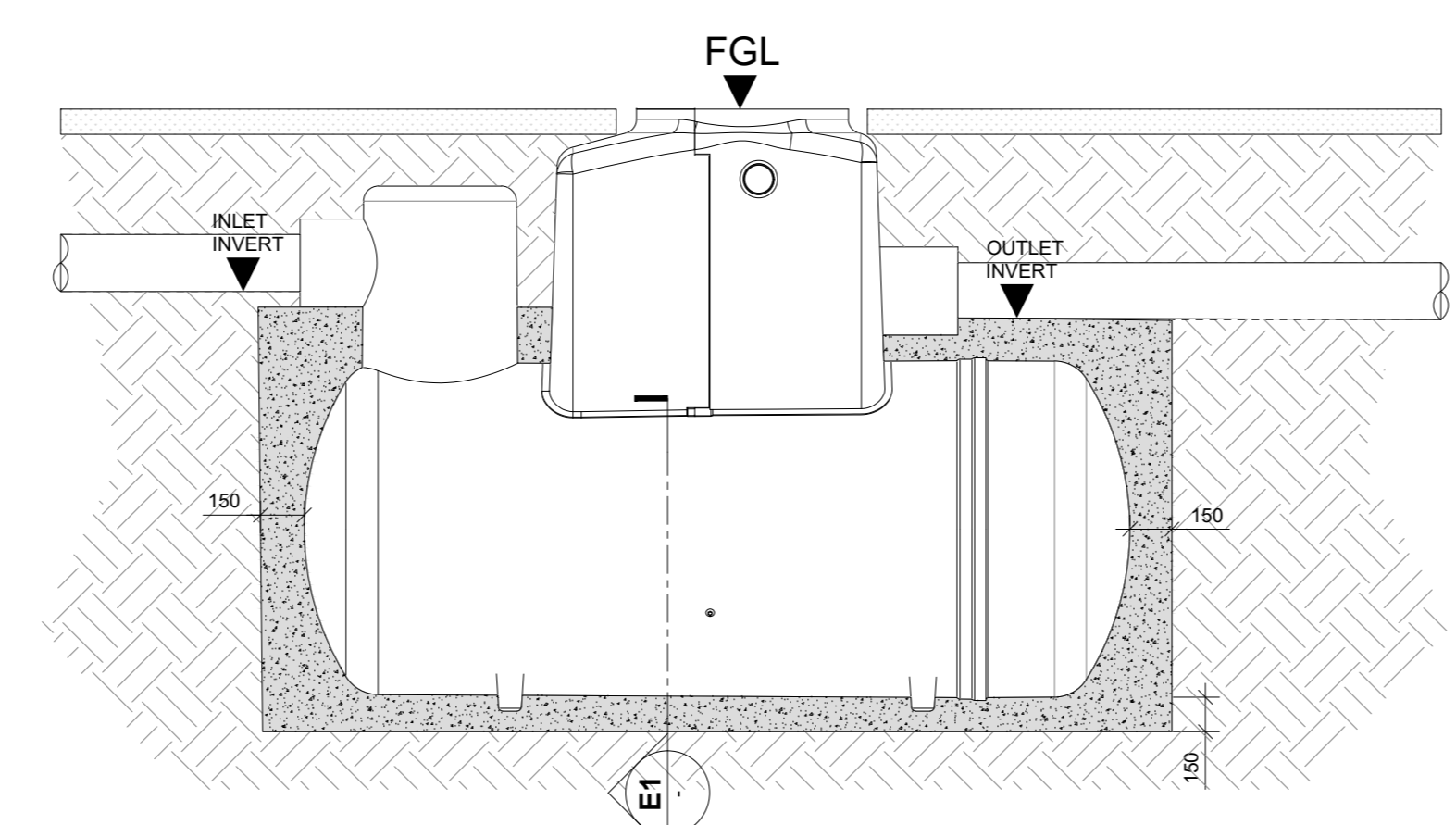

**TYPICAL BYPASS PETROL INTERCEPTOR WITH CONCRETE SURROUND DETAILS**  
SCALE @ A0: 1:25  
SCALE @ A2: 1:50

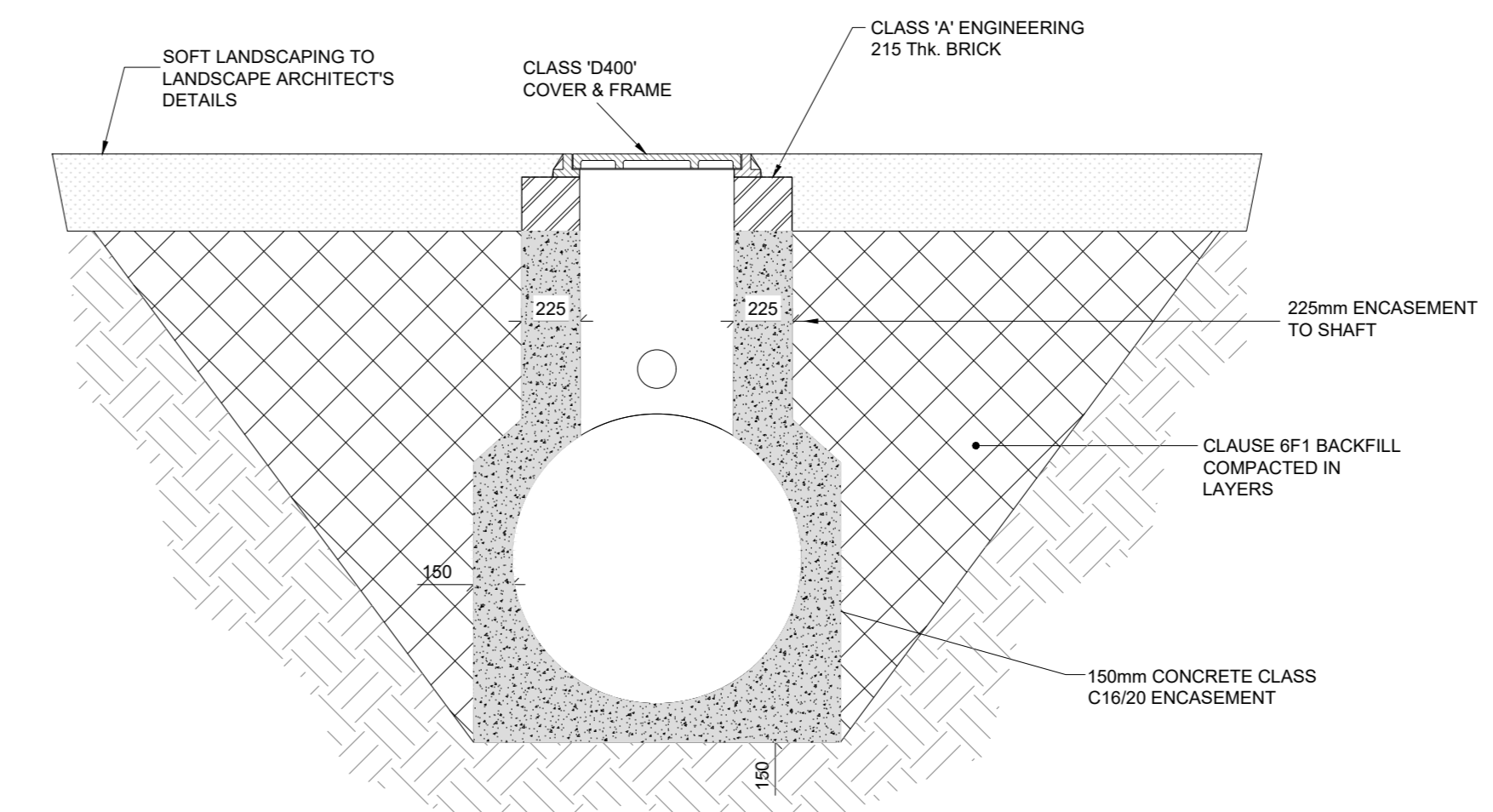

**TYPICAL SECTION THROUGH PETROL INTERCEPTOR SHOWING CONCRETE SURROUND DETAIL**  
SCALE @ A0: 1:25  
SCALE @ A2: 1:50

- NOTES:
- PROPRIETARY BYPASS PETROL INTERCEPTOR INSTALLED IN ACCORDANCE WITH MANUFACTURERS RECOMMENDATIONS.
  - INTERCEPTOR TO BE FULLY ENCASED IN MINIMUM 150mm CONCRETE.
  - INTERCEPTOR ACCESS COVER TO COMPLY WITH REQUIREMENTS OUTLINED IN DRAWING C-1200 DETAIL G FOR LIDS LOCATED IN SOFT LANDSCAPING.

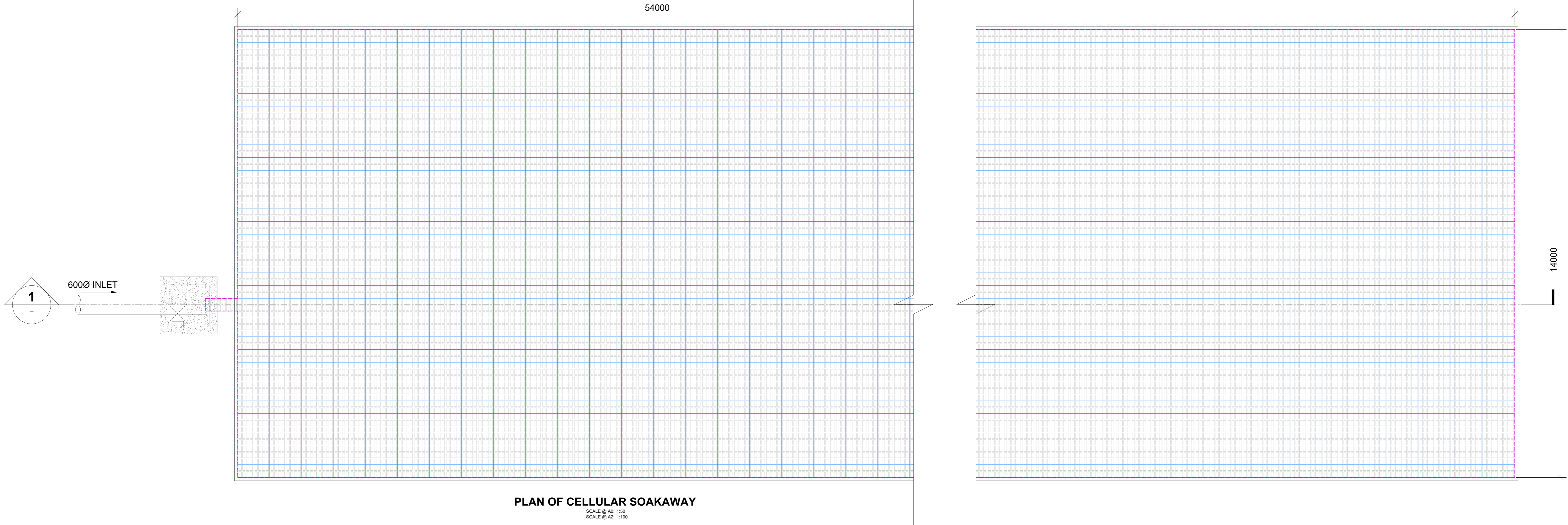

**PLAN OF CELLULAR SOAKAWAY**  
SCALE @ A0: 1:50  
SCALE @ A2: 1:100

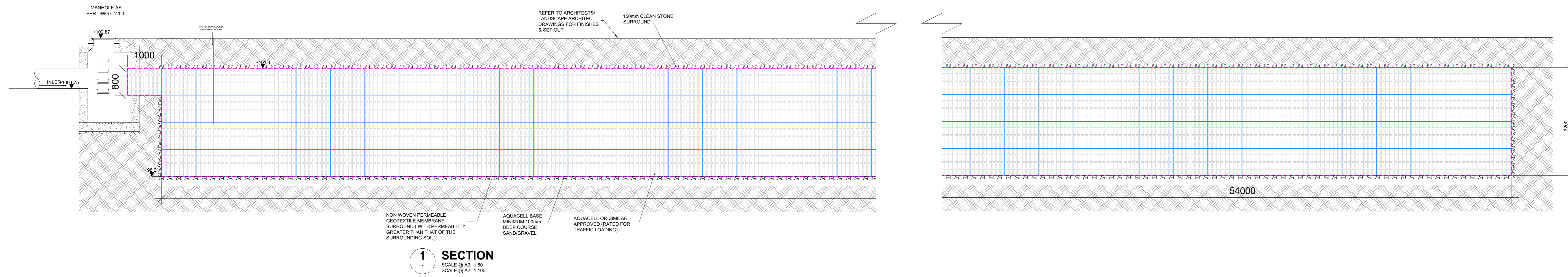

**SECTION 1**  
SCALE @ A0: 1:50  
SCALE @ A2: 1:100

|  |          |                       |     |      |             |
|--|----------|-----------------------|-----|------|-------------|
| PL2  | 05.03.21 | ISSUED FOR SUDS AUDIT | REV | DATE | DESCRIPTION |
| PL1  | 25.09.20 | ISSUED FOR SUDS AUDIT | REV | DATE | DESCRIPTION |
| ISSUE  | DATE     | DESCRIPTION           | DRG | DATE | DESCRIPTION |
| DRAWING STAGE: <b>PLANNING</b>   |          |                       |     |      |             |
|  |          |                       |     |      |             |
| CLIENT: <b>CAIRN HOMES PROPERTIES LTD.</b><br>PROJECT TITLE: <b>COOKSTOWN ROAD, ENNISKERRY, CO. WICKLOW.</b><br>MODEL REFERENCE: <b>18243-BMD-00-ZZ-DR-C-1205</b><br>DRAWING TITLE: <b>SUDS DETAILS (SHEET 1 OF 2)</b> |          |                       |     |      |             |
| DRAWING NO: <b>18243-BMD-00-ZZ-DR-C-1205</b>   |          |                       |     |      |             |